

VEGGY GARDEN AREA

The new subtropical border, which is a lushy backdrop for the view from the main garden, flanks the path leading to the secluded veggy garden, where herbs are grown in the raised garden and citrus trees are neatly planted in front of the big house window.

TRAMPOLINE AREA

The trampoline remains out of the view from the main garden, but with the additional planting along the hedge of the gully it is embedded in a lushy, subtropical scenery.

MAIN GARDEN

The main garden is characterised by a big lawn at level with the pool-deck. A couple of evergreen hedges along the two smaller sides contribute to provide privacy.

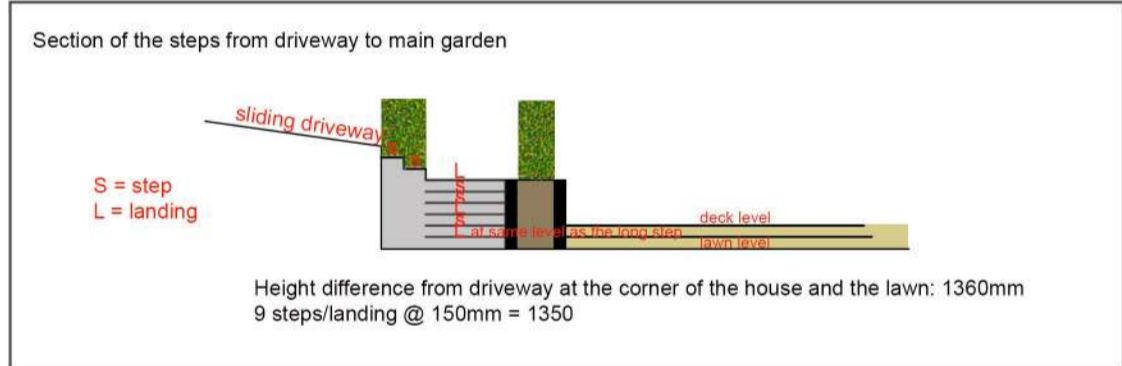
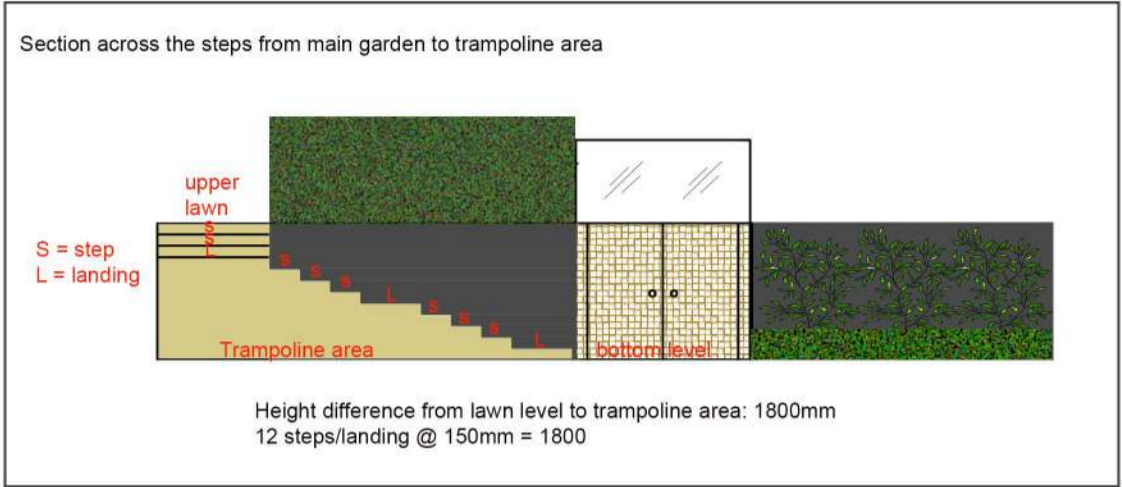
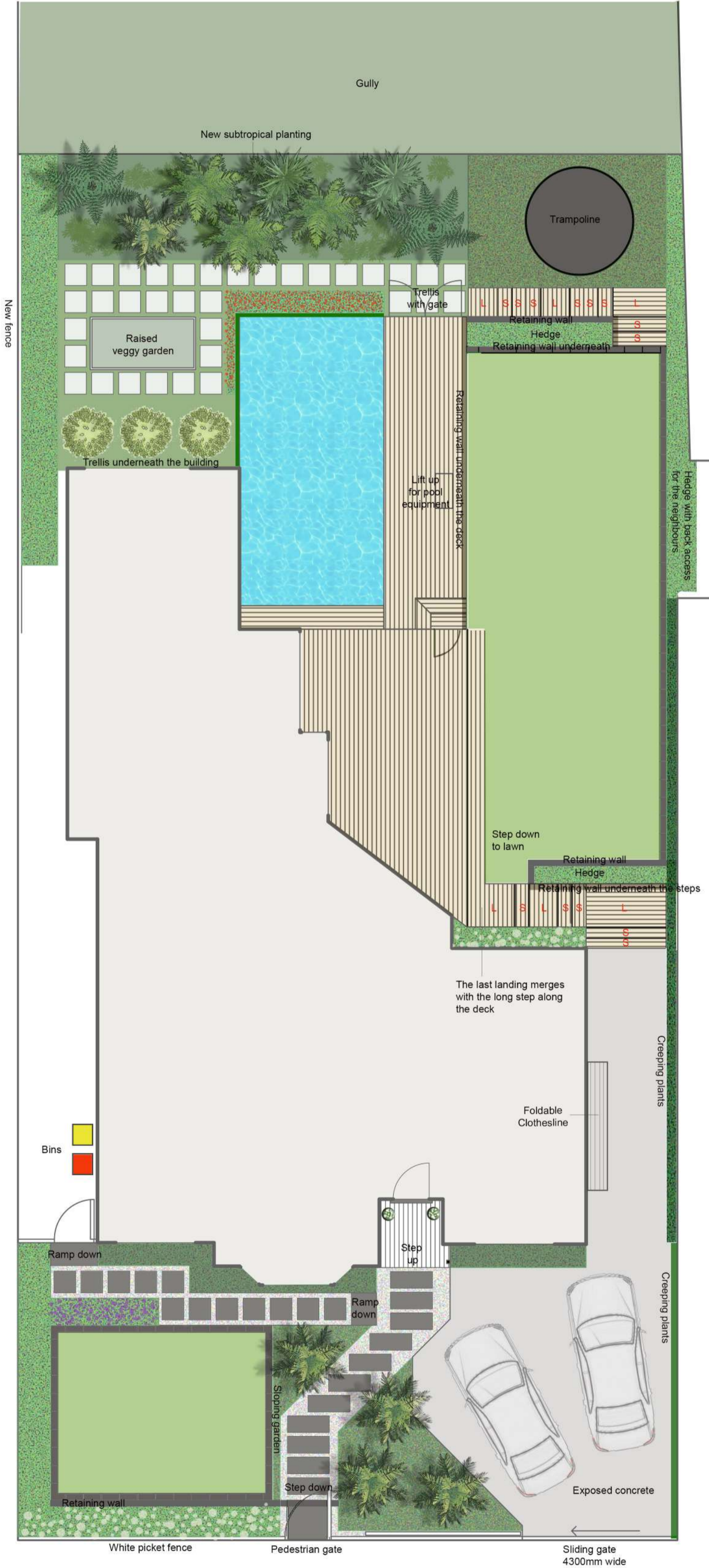

ENTRANCE YARD

The entrance yard is characterised by a landscape design crisp and clean with clear lines and a restricted plant palette. The diagonal path of charcoal pavers in white stones allows to integrate smoothly the concrete paved parking area with the cozy, green side of the garden.

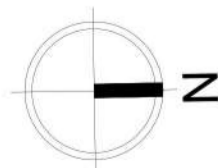

These drawings have been accurately prepared and scaled, however as the information may have been derived from a range of sources, a site check is recommended for verification before commencing works.



SCALE 1:100@A2

Concept Design	Mark Litherland Phone 09 574 5000 Mobile 021 427 336 info.021garden@gmail.com www.021garden.co.nz		Scale 1:100	Date 16.04.2019	Drawing 021garden
	Project 50 Victoria Road, Remuera, 1010 Auckland		Board Board #1 - Hard landscape		